

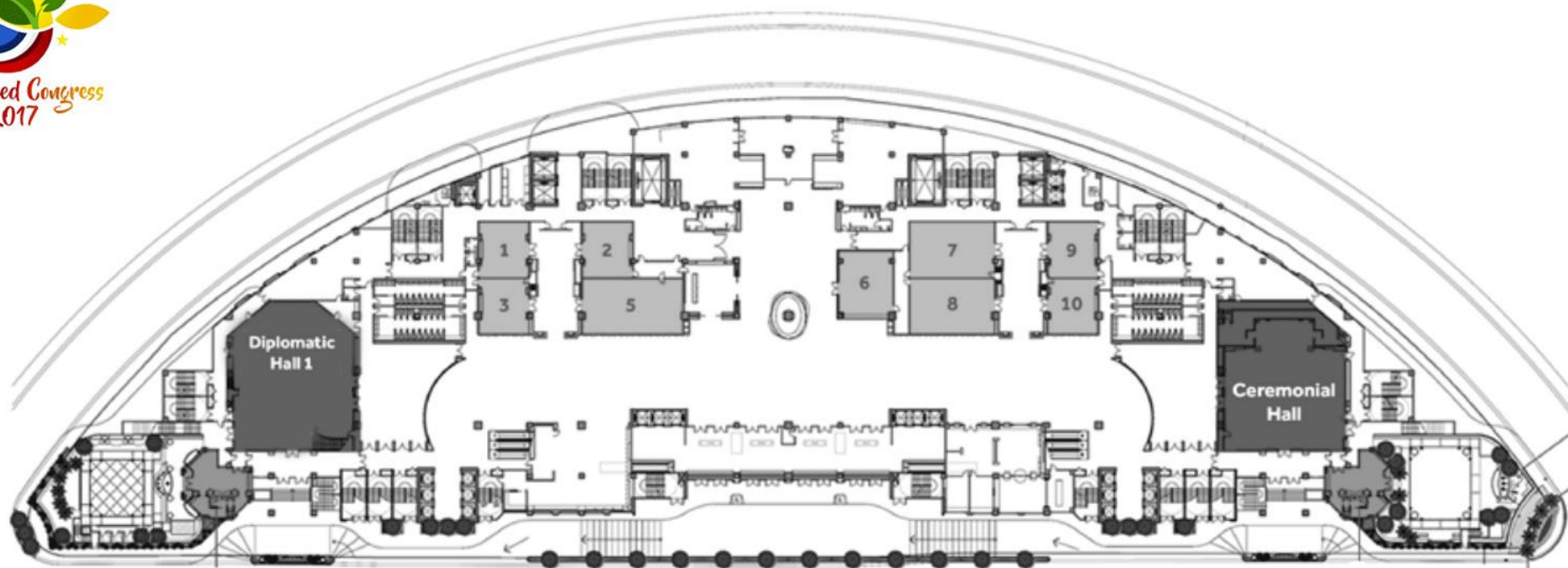

Ground Floor





- A. Trading Tables
- B. Exhibition Booths
- C. Semi Private Trading Table
- D. Registration and APSA Booth

2nd Floor

Walkway connecting to the  
Marriott Manila Hotel

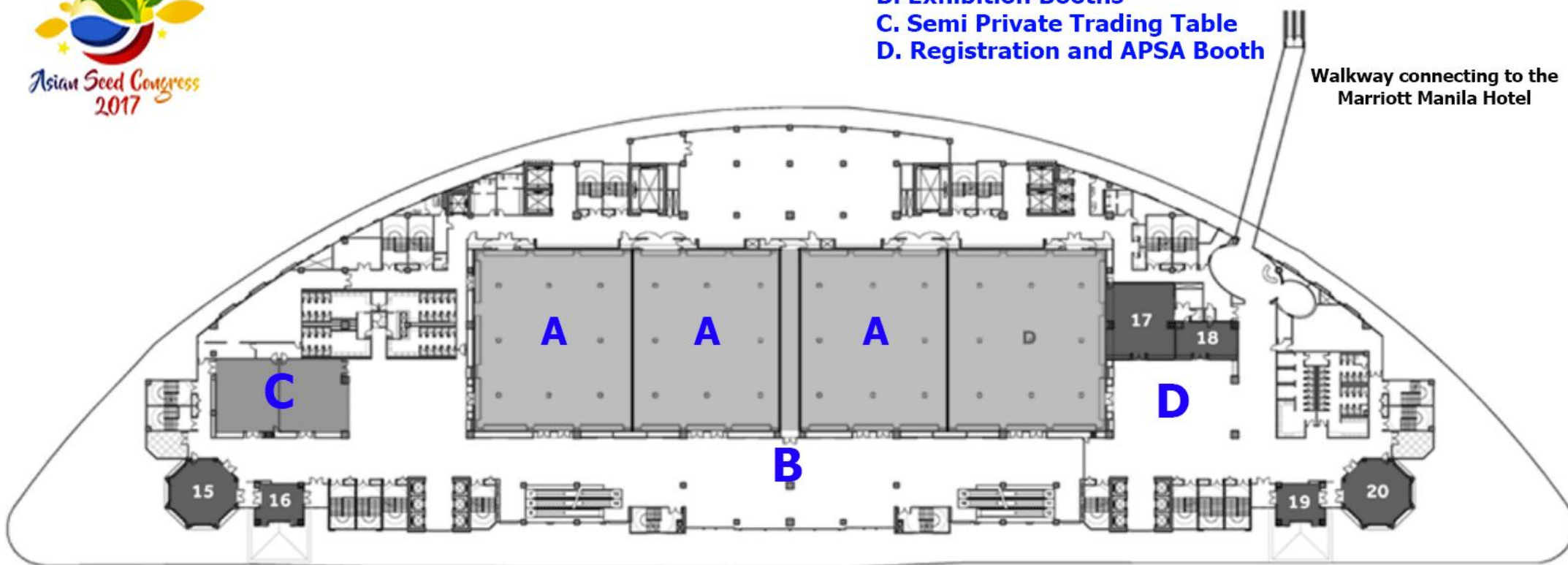



## Sky Boxes

3rd Floor

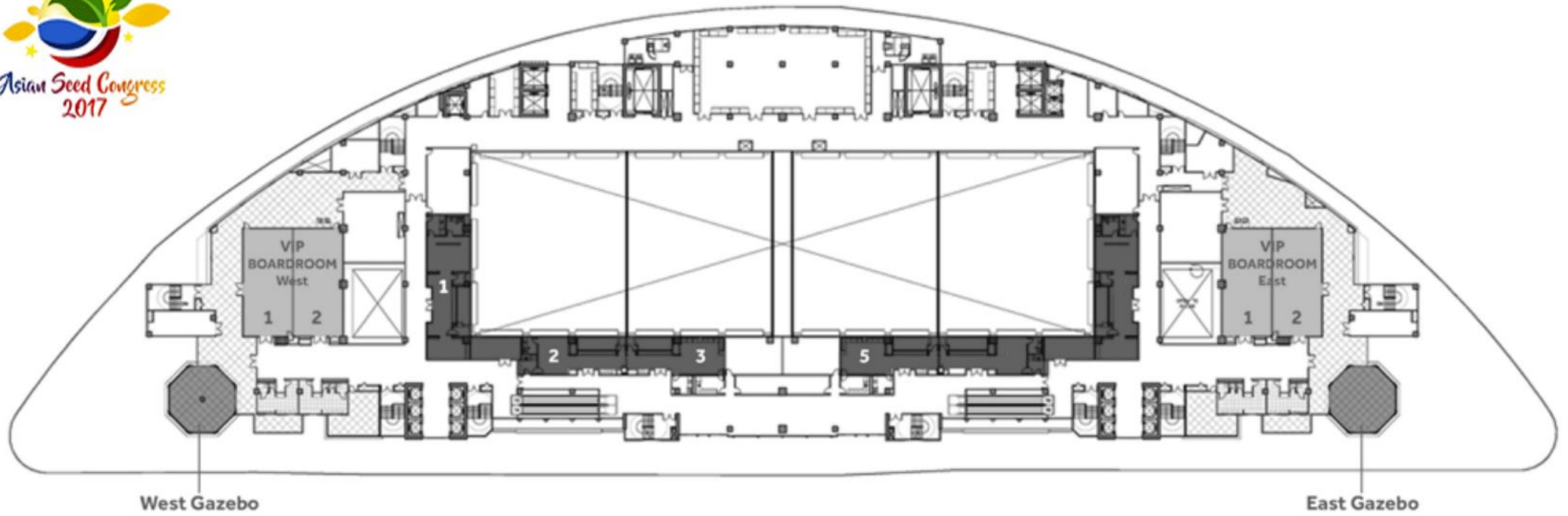



## EXHIBITION BOOTHS 2nd Floor

No. Booths

Premium Booths => 4

Corner Booths => 24

Regular Booths => 18

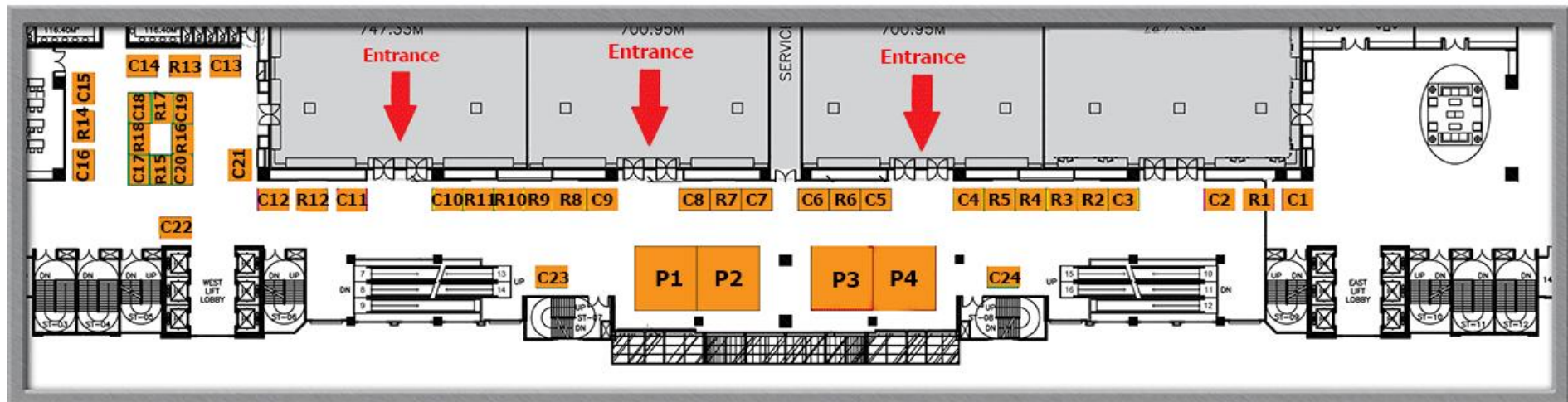



Item	Rates
<b>Registration</b>	
<b>Delegates</b>	
<b>Members</b>	
Early Bird	\$700
Late	\$750
Onsite	\$800
<b>Non-members</b>	
Early Bird	\$1,600
Late	\$1,650
Onsite	\$1,700
Partners and accompanying persons	\$350
<b>Exhibition Booths</b>	
<b>Members</b>	
Regular (2x3)	\$3,000
Corner (2x3)	\$5,000
Premium Booth (6x6)	\$20,000
<b>Trading Table</b>	
<b>Members</b>	
Regular Trading Table	\$650
Semi-Private Trading Table	\$1,500
Private Meeting/Event Room	\$8,000
Sky Boxes (Above Trading Hall )	\$15,000
<b>Sponsorship</b>	
Gold	\$50,000
Silver	\$20,000
Bronze	\$5,000